

REZ 3-3'

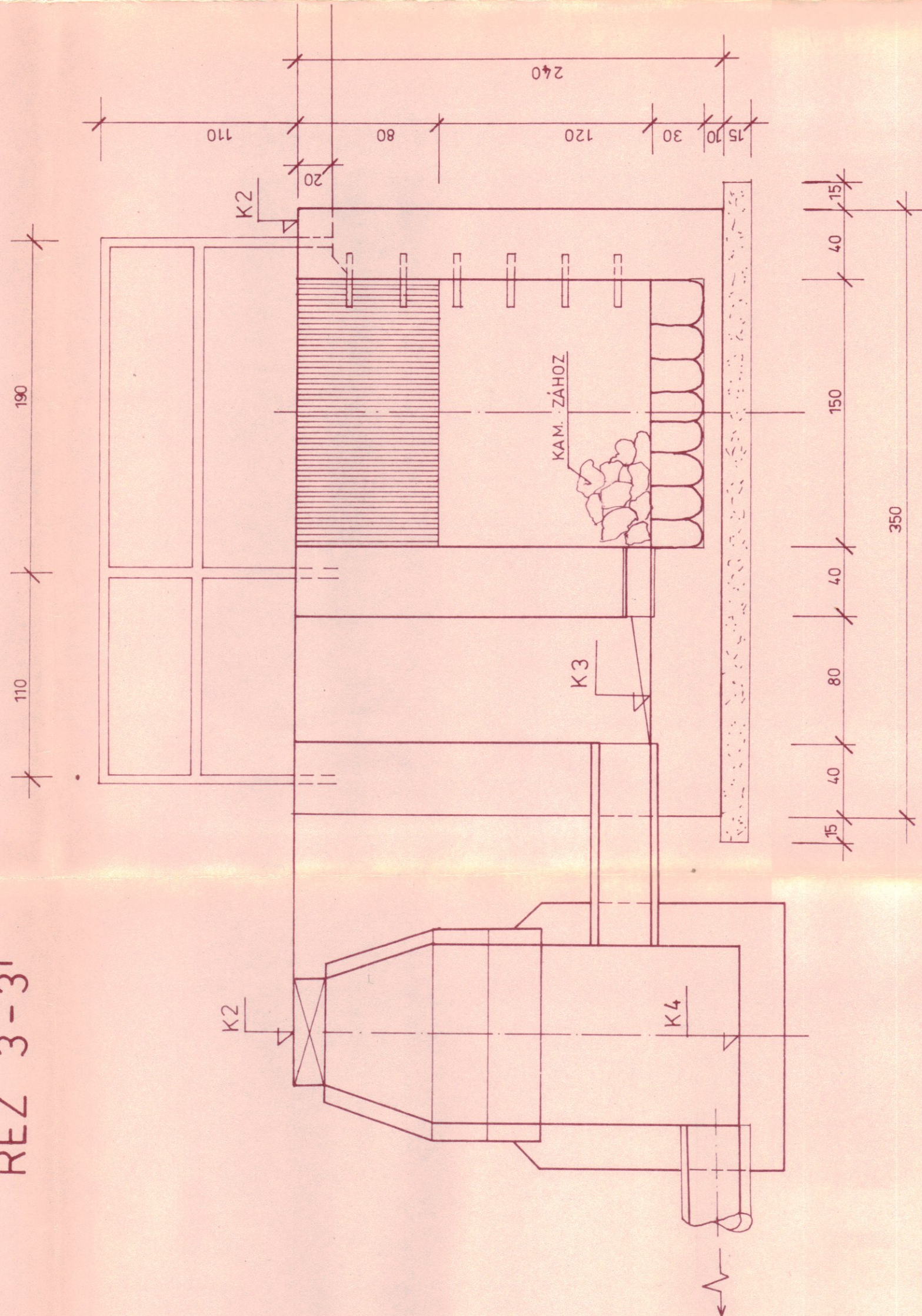

REZ 1-1'

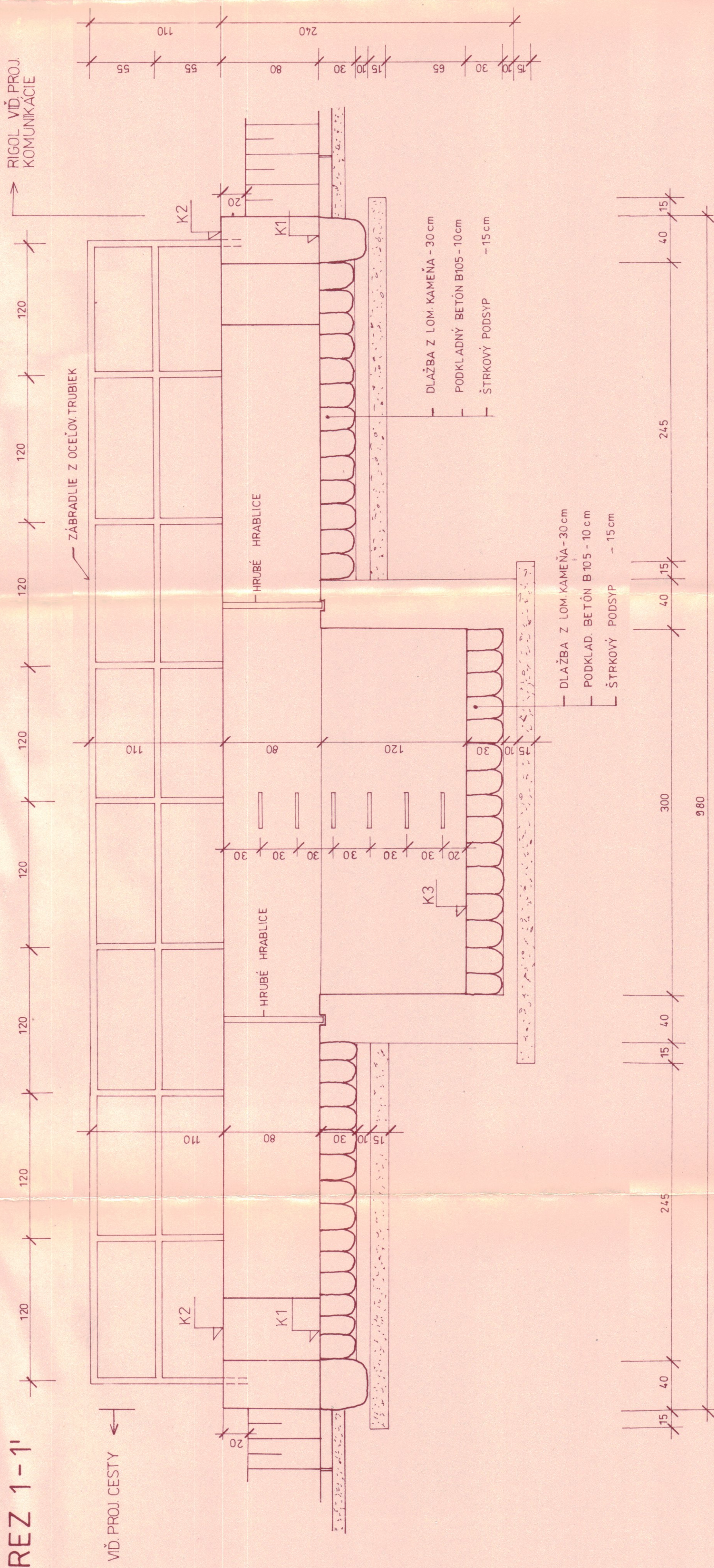

REZ 2-2'

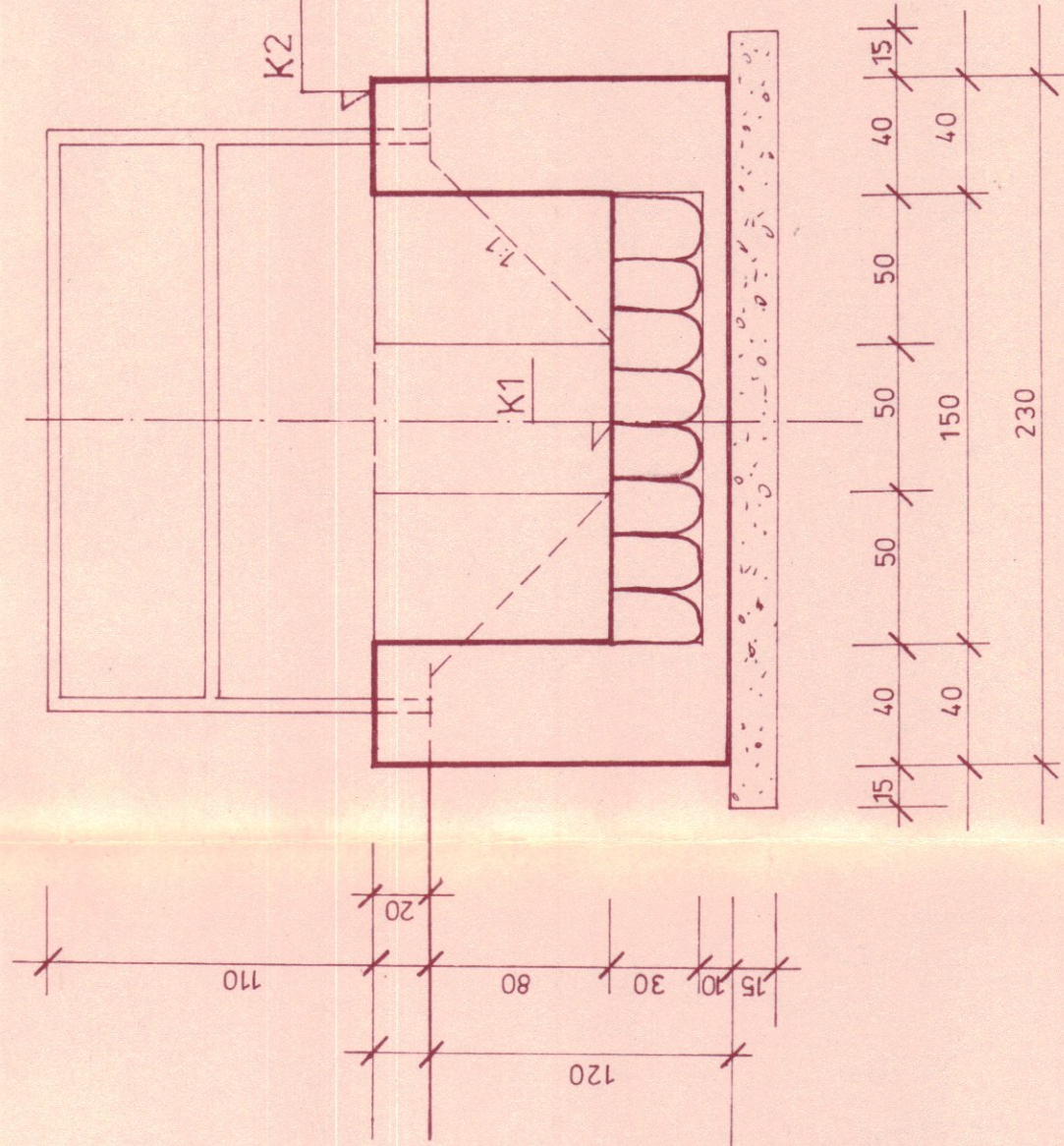

KÓTY K1, K2, K3, K4, PLATIA PRE LAPAC SPLAVENN L1, L3, L5				
LAPAC	K1	K2	K3	K4
L1	140,40	141,20	139,20	138,70
L3	163,0	163,80	161,60	161,70
L5	186,40	187,20	185,20	183,70

II	ING. GRIGER	11/1	KANALIZAČNÝ ZBERAČ A VIII-8-1 V KOMUNIKÁCI A 2	ING. ARCH. SLIŽ ING. ZDIMAL VP IX. 85 15.11 8587/38	1:25	11
	ING. HRICO	11/1				
	ING. HRICO					
	NETROUFALOVÁ					
	ING. ZDIMAL					
KANALIZÁCIA			LAPAC SPLAVENNÝ VHM			